



CAUTION

Before use, thoroughly read MAXAIR® CAPR® P/N 03521015 User Instruction (received with all CAPR Helmets and available at www.maxair-systems.com).



REF 2270-01SM
Small-Medium
P/N 01031417

REF 2270-01ML
Medium-Large
P/N 01031425

Intended Use

The MAXAIR CAPR Hood Systems filter aerosolized and droplet particulates when used with a MAXAIR CAPR Powered Air Purifying Respirator (PAPR) Helmet.

The 2270-01 Hood requires a 2165-10 Filter Cartridge be assembled to the CAPR Helmet.

Hoods are designed for single use applications.

Standard CA-CAPR-36 System with 2270-01 DLC Single Hood

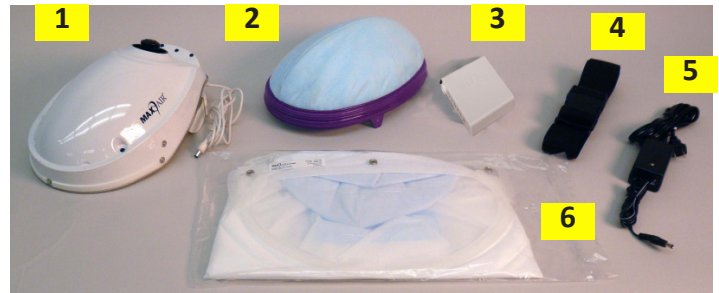

1. 2080-03 Helmet and Power Cord	4. 2000-76 Battery Belt
2. 2165-10 Post Filter Cartridge	5. 2600-01 Battery Charger
3. 2500-36TSC Battery*	6. 2270-01 DLC Pre-Filter Hood

*The 2500-37TSC is an alternate battery for the 2500-36TSC.

Symbol Definitions



Warning, Caution, or Note

REF Catalog Number **P/N** NIOSH Number



WARNING

Failure to follow User Instructions P/N 03521015 and the instructions contained herein may be hazardous to the user's health.

Use only if package is received unopened and contents are undamaged. If damage is noted, contact the shipper for replacement or repair.

Prior to using any MAXAIR® System or component, be sure to be familiar with the system's NIOSH approved configuration.

DO NOT use if any component is damaged. If any components are damaged or contaminated and therefore unfit for safe and effective use, they should be replaced immediately.

Only trained and experienced personnel who have read and understand the User Instructions should use MAXAIR Products.

The institution using this product in any application is responsible for determining the appropriateness of this equipment relative to regulatory requirements. Bio-Medical Devices Intl, Inc. does not recommend the appropriate systems for a particular institution or facility.

Use only MAXAIR Systems/ NIOSH approved compatible components.

NOT for use in atmospheres immediately dangerous to life or health (IDLH), and atmospheres containing less than 19.5% oxygen, or more than 25% oxygen.

Flammability Level I: fabric may burn if exposed to open flame.

Follow current local regulations governing biohazard waste to safely dispose of single use MAXAIR Products.

If you need more information, contact your BMDI Sales Representative, or call BMDI customer service at 1-800-443-3842.

Specifications

Material

DLC Lens is PETG
DLC Cuff is Polyurethane
Hood body is plastic coated fabric
Filter is electrostatic filter material

Recommended System Temperature Limits

Use/Handling: 0°C to 54°C at a maximum 80% Relative Humidity.
Charging: 0°C to 45°C at a maximum 80% Relative Humidity.
Storage: 0°C to 35°C at a maximum 80% Relative Humidity.

Performance

HE (NIOSH)
APF of 25

Regulatory

NIOSH

Assembly - Hood to Helmet



WARNING

Ensure that a 2165-10 Filter Cartridge is assembled to the MAXAIR CAPR Helmet before donning the Hood.



1. Remove hood from packaging and lay it on counter with lens/snaps facing up.

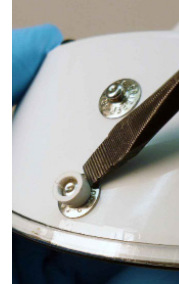

2. If necessary use a thin, flat blade to gently remove Front, Rear, and Side Adapters from their respective snaps.

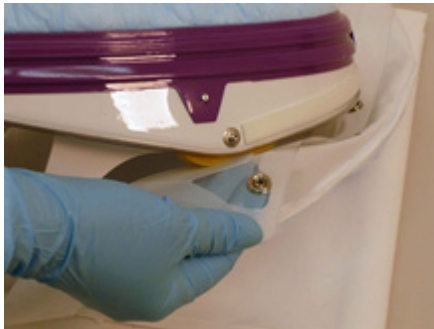

3. Snap one side of Hood DLC to one side snap of Helmet (DLC Cuff facing in).



4. Snap front of Hood DLC to center Helmet snap

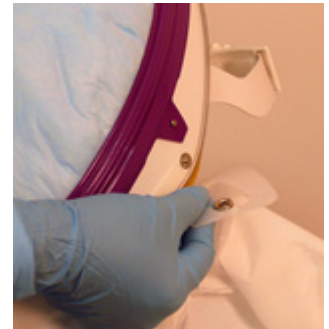

5. Snap other side of Hood DLC to other side snap of Helmet.



6. Grasp Hood Snap Tab and begin pulling hood up and over helmet.



7. Continue pulling over and down the back of the helmet.



8. Secure the Hood Snap Tab on the lower rear Helmet snap.

Disassembly - Hood from Helmet

Reverse steps 3 through 8 to remove Hood from Helmet.



WARNING

Discard all disposables per Institutional protocol for contaminated waste.

Donning - Battery and Belt



Assemble the Battery onto a double layer of Belt. Place top edge of Belt under the Battery Clip, up to the Clip top, so the Clip Detent rests on the Clip Base and NOT the Belt. Place the belt comfortably around the waist with the battery near the side-back of the right hip.

Donning - Helmet with Hood

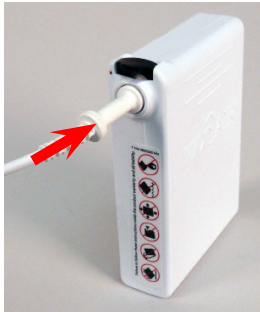

1. Connect the Helmet Power Cord to the Battery. Push the Power Cord Connector into the Battery Receptacle until the Secure Connection audibly clicks.



2. Loosen rear Ratchet Knob (counterclockwise).



3. Hold Helmet in one hand; pull Cuff down with other hand, and place chin into Cuff.



4. Pull Helmet over and down onto head.

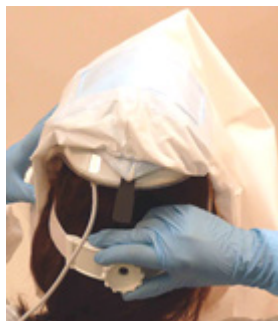

5. Secure Helmet by tightening Ratchet Knob as tight as comfortably possible, while ensuring stability.



6. Pull back of Hood over, and down behind Helmet.



7. Slide fingers between face and Cuff on both sides from chin to temples to ensure slight Cuff-to-face tension*.

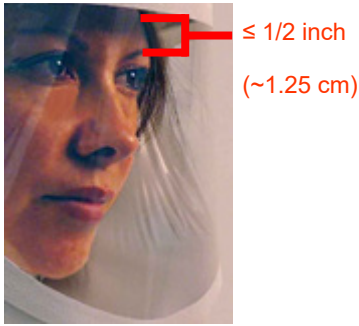

≤ 1/2 inch
(~1.25 cm)

8. Ensure that the front Headband is within 1/2 inch of eyebrows for good visualization of the Safety LEDs

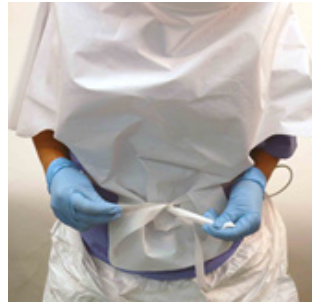

9. Pull lower ties around from back and place through tie slits in hood bottom. Tie securely.



10. Pull upper ties around and to front and tie securely under Lens. Ties should be within about 1/2 inch from neck.



11. Suitable body cover gown is recommended. Tuck Hood Shroud under body cover gown for optimum protection.

Doffing - Helmet with Hood

Reverse Donning steps 2 thru 11 to doff Helmet and Hood.



WARNING

Discard all disposables per Institutional protocol for contaminated waste.

Doffing - Battery and Belt



1. Unbuckle Belt and remove Battery and Belt from around the waste.

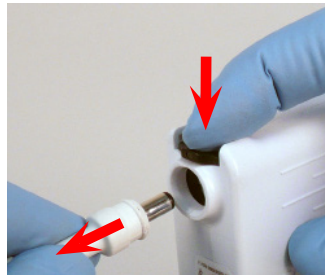

2. Disconnect the Helmet Power Cord from the Battery - Press down on the Secure Lock (Black) Button to release, then pull the cord connector out from the Battery connection receptacle.



3. With Charger connected to safe power source, connect Charger Cord to the Battery. Push Charger Cord Connector into Battery Receptacle until fully seated.



WARNING

Refer to Users Instructions (P/N 03521015) for details on chargers and charging batteries.



The entire CAPR System may be decontaminated, cleaned and/or stored at this time.