



CAUTION

Before use, thoroughly read MAXAIR CAPR P/N 03521015 User Instruction (received with all CAPR Helmets and available at www.maxair-systems.com).



DLC2

REF 2380-02

P/N 03731013

Symbol Definitions



Warning, Caution, or Note

REF

Catalog Number

P/N

NIOSH Number



WARNING

Failure to follow User Instructions P/N 03521015 and the instructions contained herein may be hazardous to the user's health.

Use only if package is received unopened and contents are undamaged. If damage is noted, contact the shipper for replacement or repair.

Prior to using any MAXAIR® System or component, be sure to be familiar with the system's NIOSH approved configuration.

DO NOT use if any component is damaged. If any components are damaged or contaminated and therefore unfit for safe and effective use, they should be replaced immediately.

Only trained and experienced personnel who have read and understand the User Instructions should use MAXAIR Products.

The institution using this product in any application is responsible for determining the appropriateness of this equipment relative to regulatory requirements. Bio-Medical Devices Intl, Inc. does not recommend the appropriate systems for a particular institution or facility.

Use only MAXAIR Systems/ NIOSH approved compatible components.

NOT for use in atmospheres immediately dangerous to life or health (IDLH), and atmospheres containing less than 19.5% oxygen, or more than 25% oxygen.

Flammability Level I: fabric may burn if exposed to open flame.

Follow current local regulations governing biohazard waste to safely dispose of single use MAXAIR Products.

If you need more information, contact your BMDI Sales Representative, or call BMDI customer service at 1-800-443-3842.

Intended Use

The MAXAIR DLC2 is to be donned with a MAXAIR CAPR® Helmet and a MAXAIR Filter Cartridge.

CAPR DLC2 Systems filter aerosolized and droplet particulates.

DLC2s are designed for single use applications.

Standard CA-DLC-CAPR-36 System¹ with DLC2



1. 2081-03 Helmet with 2051-07 SnapOn Cage removed, 2071-08 Liner, and 2590-05 Power Cord	2. 2167-10 Filter Cartridge
	3. 2061-08 Filter Cover Cap
4. 2500-36TSC Battery*	5. 2000-76 Battery Belt
6. 2600-02 Battery Charger	7. 2380-02 DLC2

Alternate Batteries include the 2500-37TSC

Specifications

MAXAIR Recommended System Temperature Limits:

Use/Handling: 0°C to 54°C at a maximum 80% Relative Humidity.

Charging: 0°C to 45°C at a maximum 80% Relative Humidity.

Storage: 0°C to 35°C at a maximum 80% Relative Humidity.

All MAXAIR Systems, components, and disposables are latex free.

Materials

DLC2 Lens is Polycarbonate

DLC2 Cuff Blue White Barrier

Regulatory

NIOSH



WARNING

The DLC2 Cuff side must face to the inside of the Helmet; the Lens side must face to the outside of the Helmet. Ensure that the Lens Protective Cover is removed (OFF) from the Lens before use.



Assembly



NOTE

Assembly of DLC to Helmet is the same steps before or after the Helmet is donned.



1. Align FCC front TurnClip horizontally, snap the DLC2 Front Alignment Hole over the TurnClip, then position TurnClip vertically to lock DLC2 in place.

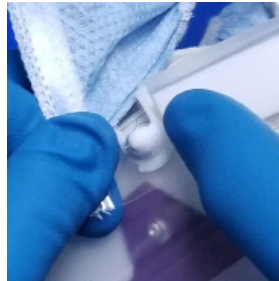

2. Align and snap one DLC2 Side Attachment Hole over the respective FCC Side Attachment Post. Repeat for other side.

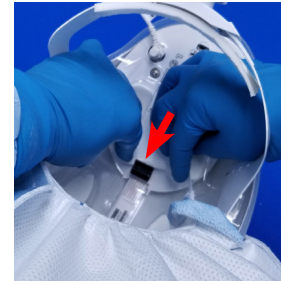

3. Loop the DLC2 Attachment Band under the Helmet Band Clip.

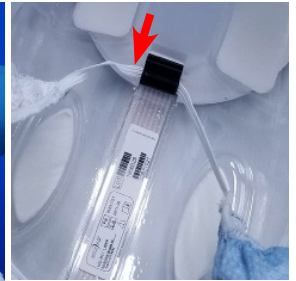

Donning

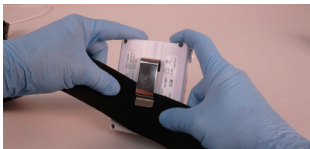

1. Assemble the Battery onto the Belt. Place the top edge of the Belt under the Battery Clip. Move the Belt fully under and up to the top of the Clip. Place the belt comfortably around the waist with the battery near the side-back of the right hip.

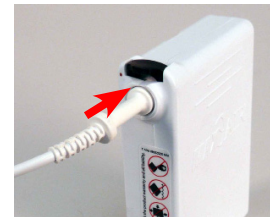

2. Connect the Helmet Power Cord to the Battery. Push the Power Cord Connector into the Battery Receptacle until the Secure Connection audibly clicks.



3. Loosen the rear Headband Adjustment Knob by turning it counterclockwise.



4. Hold Helmet by rear headband, pull front top edge of DLC2 Cuff down, place chin into DLC2 Cuff. Pull Helmet over and down on to head.



5. Tighten rear Headband Adjustment Knob clockwise. Ensure a tight but comfortable fit for all activities.



6. Slide fingers between Cuff and face from each temple down and under chin so Cuff is smoothly around and close to back of face and chin.



WARNING

After donning, ensure that conditions 1 and 2 both are achieved above.

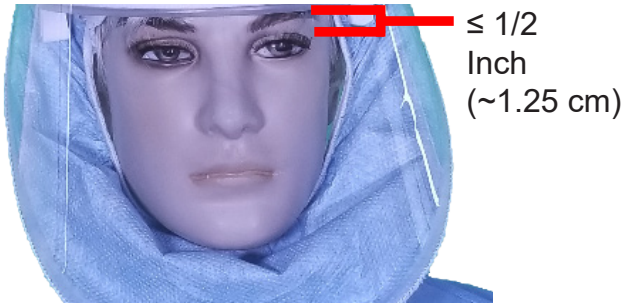

Condition 1: Position the Helmet so that the front headband is within 1/2 inch of the eyebrows and the rear headband is resting under the occipital bone above the vertebrae on the neck, and then tighten the Adjustment Knob clockwise to ensure the most secure fit of the helmet on the head for all activities. Do not over tighten to cause discomfort.

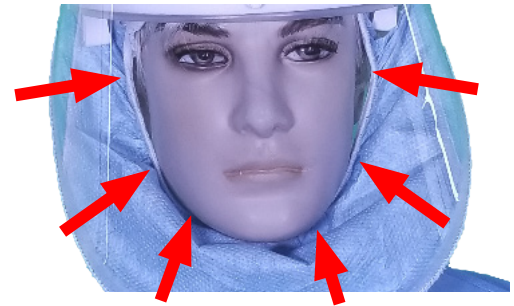

Condition 2: Ensure slight tension on the cuff is felt continuously while sliding the index or first finger between the cuff and the face all along the chin and up to the temples, from the right side of the face to the left.



CAUTION

Optimum setting is achieved when the helmet is secure on the head for all movements required and the front headband is within 1/2 inch of the eyebrows to allow good visualization of the LED Safety Status Indicators in the upper peripheral vision.



CAUTION

If the Helmet is not secure and comfortable on the head, it may be necessary to change the Height Adjustment. The Height Adjustment raises and lowers the rear headband and the angle of the helmet with respect to the head, and properly positions the DLC Lens from the chin. This optimizes a secure and comfortable fit in conjunction with the Adjustment Knob for optimizing the circumference of the Headband. It also aids in proper positioning for easy visualization of the LED Safety Status Indicators. If necessary, unsnap the Height Adjustment tabs on each side of the Helmet Liner and reposition upward or downward, until the optimum fit for comfort and security is determined. Be sure to have both Height Adjustment tabs in the same position.



Doffing



1. Loosen the rear Headband Adjustment Knob (turn counterclockwise).



2. Pull the DLC2 Cuff away from the chin. Lift the Helmet up, forward, and off the head.

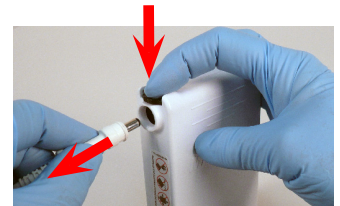

3. Disconnect the Helmet Power Cord from the Battery - push the Secure Connection Button down, pull Cord Connector out, release the Button.



4. Disconnect the Battery Belt from around the waist by un-snapping the buckle.



5. With the Charger connected to the mains wall power, connect the Charger Cord to the Battery. Push the Charger Cord Connector into the Battery Receptacle until it is fully seated.



WARNING

Refer to Section 9, User Instruction Manual P/N 03521015, for details on proper use of chargers and for charging batteries.

Disassembly

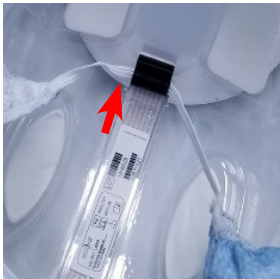

1. Remove DLC2 Attachment Band from the Helmet Band Clip.

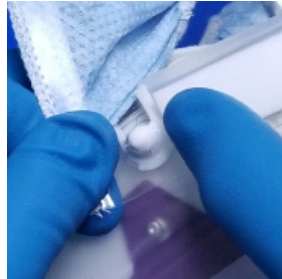

2. Lift each side DLC2 Side Attachment Hole up and off the respective FCC Side Attachment Post.

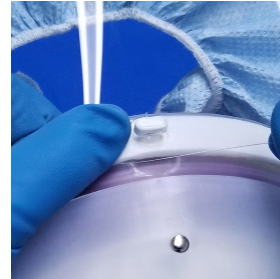

3. Align FCC front TurnClip horizontally, lift the DLC2 Lens Front Alignment Hole off the TurnClip.

4. Dispose of the DLC2 according to your institution's protocol for contaminated waste.

The entire CAPR System may be decontaminated, cleaned and/or stored at this time. Refer to User Instruction Manual, P/N 03521015, for cleaning and maintenance details.



CAUTION

Always read and understand the User's Instructions, P/N 03521015, shipped with each MAXAIR Helmet, before using any MAXAIR System. (available at www.maxair-systems.com>SUPPORT>USER MANUALS)